



**WARNING:** To ensure correct alignment of pulleys and to prevent the damper fouling on the timing cover it is essential that the enclosed 0.157” thick spacer **MUST** be pushed onto crankshaft snout prior to installing the PRO/RACER crankshaft damper.

**WARNING:** To ensure correct alignment of pulleys and to prevent the damper fouling on the timing cover it is essential that the enclosed 0.157” thick spacer **MUST** be pushed onto crankshaft snout prior to installing the PRO/RACER crankshaft damper.

**WARNING:** To ensure correct alignment of pulleys and to prevent the damper fouling on the timing cover it is essential that the enclosed 0.157” thick spacer **MUST** be pushed onto crankshaft snout prior to installing the PRO/RACER crankshaft damper.

**WARNING:** To ensure correct alignment of pulleys and to prevent the damper fouling on the timing cover it is essential that the enclosed 0.157” thick spacer **MUST** be pushed onto crankshaft snout prior to installing the PRO/RACER crankshaft damper.

**WARNING:** To ensure correct alignment of pulleys and to prevent the damper fouling on the timing cover it is essential that the enclosed 0.157” thick spacer **MUST** be pushed onto crankshaft snout prior to installing the PRO/RACER crankshaft damper.

**WARNING:** To ensure correct alignment of pulleys and to prevent the damper fouling on the timing cover it is essential that the enclosed 0.157” thick spacer **MUST** be pushed onto crankshaft snout prior to installing the PRO/RACER crankshaft damper.

**WARNING:** To ensure correct alignment of pulleys and to prevent the damper fouling on the timing cover it is essential that the enclosed 0.157” thick spacer **MUST** be pushed onto crankshaft snout prior to installing the PRO/RACER crankshaft damper.

**WARNING:** To ensure correct alignment of pulleys and to prevent the damper fouling on the timing cover it is essential that the enclosed 0.157” thick spacer **MUST** be pushed onto crankshaft snout prior to installing the PRO/RACER crankshaft damper.

**WARNING:** To ensure correct alignment of pulleys and to prevent the damper fouling on the timing cover it is essential that the enclosed 0.157” thick spacer **MUST** be pushed onto crankshaft snout prior to installing the PRO/RACER crankshaft damper.



**INSTALLATION INSTRUCTION—SPACER PONTIAC**  
#64275 V8 Damper – 326-400-455 Cu. In.

**IMPORTANT: Before attempting installation please read these instructions fully.**

**NOTE:** To determine whether a Spacer is required prior to installing the Pontiac #64275 Damper, it is necessary to check either of the dimensions below. Your measurements will either be identical to those shown, or they will be 0.157" short of these dimensions.

If either dimension measures 0.157" shorter than shown below (i.e. either 2.835" if measuring the overall length, or 2.678" if measuring to the pulley mounting face) it is necessary to install the 0.157" Spacer onto the crankshaft snout prior to installing the PRO/RACER crankshaft Damper.

**IMPORTANT: DO NOT drill any holes in your PRO/RACER Damper as this may void SFI 18.1 Certification.**

**Correct Dimensions for Pontiac #64275 Damper**

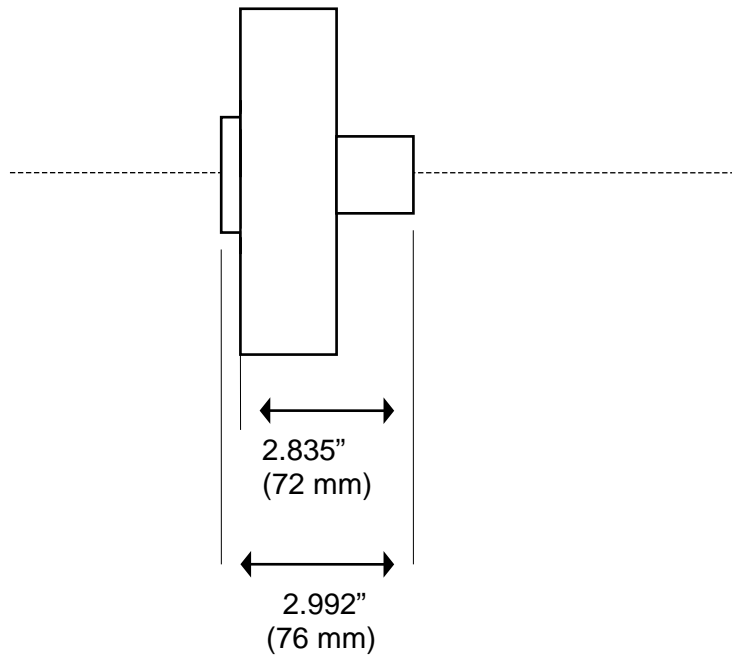

Should you have any difficulty fitting your PRO/RACER "All Steel Crankshaft Vibration damper, please contact:

USA: PRO/RACE Tech-line  
Australia: PRO/RACE Tech-line  
Email: tech@pro-race.com

Tel: 734 740 0922  
Tel: + 61 3 9584 3522 Fax: + 61 3 9584 5194  
Website: www.pro-race.com

Oct 2018